

# PS 10

**LIFT TRUCK WITH  
MANUAL TOW**

**ELECTRIC LIFT WITH  
BATTERY 12V - 92 Ah**

**ON REQUEST DRIVING TYPE  
BATTERY 12 110 Ah  
FOR GREATER AUTONOMY**

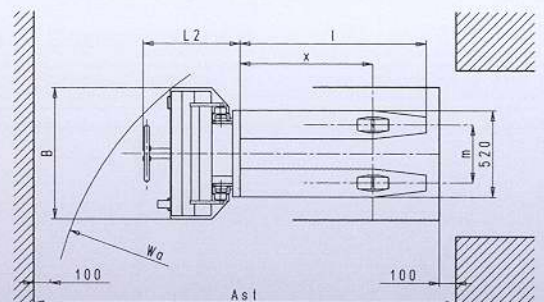
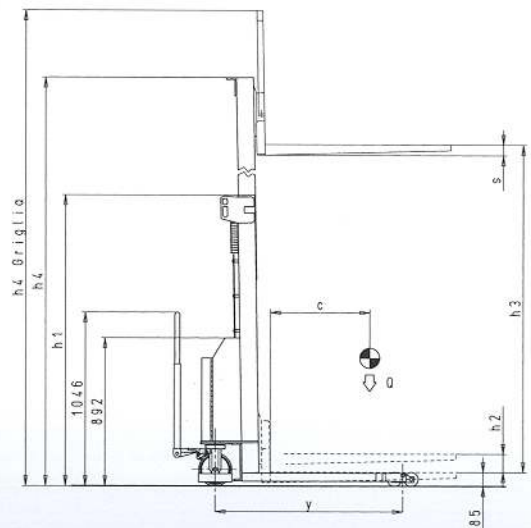

## TECHNICAL DATA PS 10

**FRAME** - The frame and the forks are made with high resistance sheet steel, ensure maximum strenght and durability, and can reduce the weight of the machine with consequent improvement of the truck's movement.

**MAST** - Made with highly resistant and rigid ST 52.3 steel profiles.

**HYDRAULIC LIFT GROUP** - Closed motor, 1300 W 12 V, coupled by means of a flange to the gear pump for high pressure.

The lift/lowering controls of the cylinder/mast group is carried out by means of a lever distributor that regulates speed in a very sensitive way.

Simple effect cylinder with a chromed rod.

Equipped with: maximum pressure valve that limits at a pre-established value the load to be lifted; non-return valve; flux compensating valve included in the base of the lifting cylinder, that ensures controlled load descent even in cases of broken tubes.

**STEERING** - Controlled by a handle that is also used for pulling. A particular leverage system enables the operator with minimum effort to obtain a very reduced steering radius.

**BATTERY CHARGER** - It is supplied separately from the truck.

**MAXIMUM LIFTING SPEED** - 6 mt/1' unladen; 4,5 mt/1' with 1000 Kg load.

**MAXIMUM DESCENT SPEED** - 15 mt/1' unladen and with load.

*The machines are equipped with all the safety devices foreseen by the norms in force.*

## OVERALL DIMENSIONS LIFT GROUPS

LIFT HEIGHT	1700	2500	3000	3500	4000
Q Kg	1000	1000	1000	700	300
C mm	600	600	600	600	600
h3	1620	2425	2920	3420	3920
h2	1620	110	110	110	110
S x l	60x1120	60x1120	60x1120	60x1120	60x1120
m	350	350	350	350	350
L2	565	585	585	585	585
B	790	790	790	790	880
h1	2030	1750	2000	2260	2510
h4	2055	2910	3405	3915	4415
Wa	1945	1945	1945	1945	1867
X	820	799	799	799	799
Ast	2525	2546	2546	2546	2468
Weight Kg	350	430	445	475	520
y	1131	1131	1131	1131	1131
h4 grid	2510	3315	3810	4310	4810

## TRUCKS WITH MANUAL DRIVE



P INOX



P

PS 10



**INOX**